



D130 PRO SPEC
UPGRADE SET

FOR

BRX02

D130

LAND ROVER DEFENDER 130 HIGH CAPACITY PICKUP
1/10 SCALE 4WD RC KIT

www.EnjoyBeingABadass.com

PRODUCT CODE: BRX027048 INSTRUCTION MANUAL V1.0



Apply Double Sided Tape



Pay attention to note



Apply Glue



Thread Lock



Drill Hole



Black Graphite Grease

Tools Included



Ø1.0mm Drill Bit



Ø1.2mm Drill Bit



Ø1.7mm Drill Bit

Tools Required



Phillips Head Screwdriver (Large)

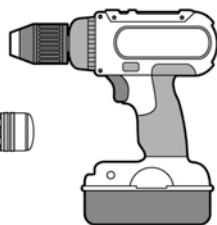

Drill

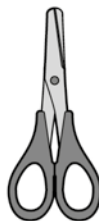

Scissors



Hobby Knife

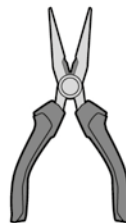

Long Nose Pliers

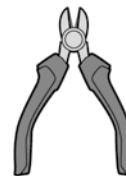

Side Cutter



Model Filler



Glue

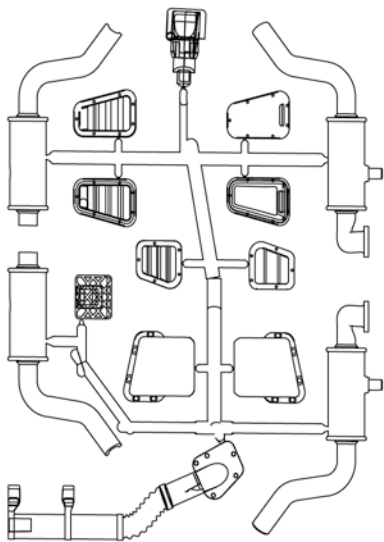

ST1.2x4 RS x 5

M3x6 RS x 2

#BRX027049



Stainless Steel Mesh Set x 1

#BRX027055

Metal Mirror Mount x 2

ST1.5x4 CSS x 4

ST2x6 RS x 2

#BRX027053

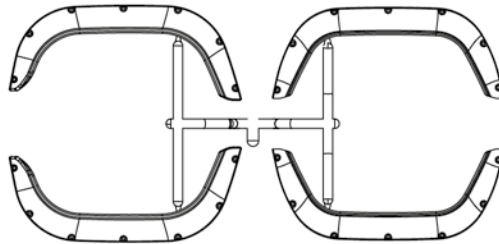

Pro Spec Wheel Arches x 1

ST1.5x4 RS x 28

#BRX027050

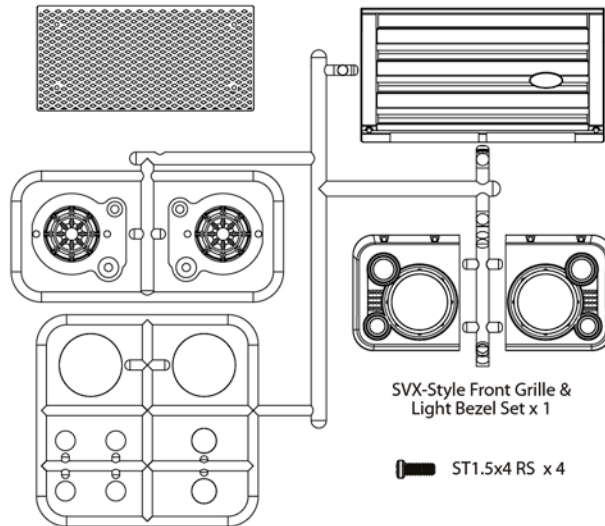
SVX-Style Front Grille &
Light Bezel Set x 1

ST1.5x4 RS x 4

#BRX027052



KUDU™ Steel Tubular Rock Sliders x 2

M3x6 CSS x 6

#BRX027051

Mirror-Finish Stainless Steel Side
& Rear Mirror Set x 1

#BRX027054

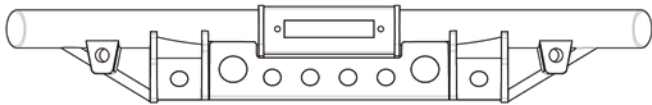

Tubular Alum Front Bumper x 1

#BLC70219F

#BRX02413

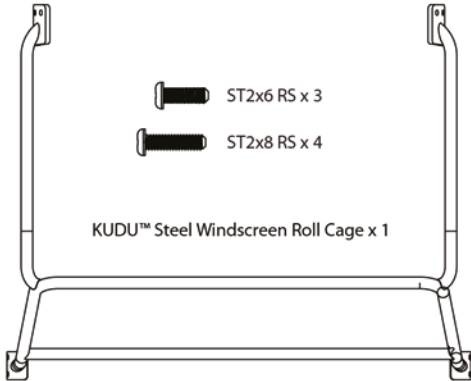

KUDU™ Steel Windscreen Roll Cage x 1

ST2x6 RS x 3

ST2x8 RS x 4

M3x4 Set Screw x 2

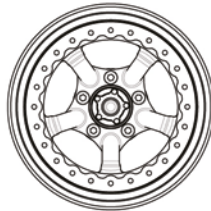

ProBuild 1.9" Extra Wide Spectre Adjustable Beadlocks Wheels x 4
#BRPB050BKBK-EW



Center Cap Tool x 1
#BRT10060



D4 x 7 x 1
Stainless Steel Spacer x 3
#BRASSP471

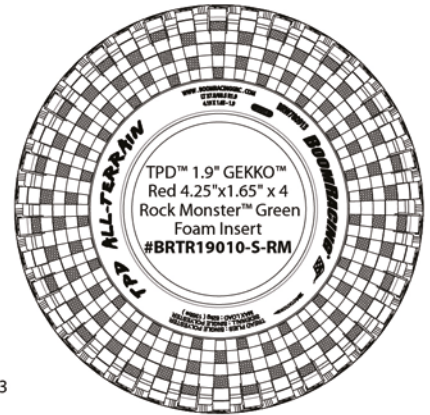

TPD™ 1.9" GEKKO™
Red 4.25"x1.65" x 4
Rock Monster™ Green
Foam Insert
#BRTR19010-S-RM

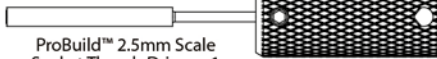

ProBuild™ 2.5mm Scale Socket Thumb Driver x 1
#BRPROB-16



KUDU™ 52mm Solid Axle Coil Spring Green (Medium) x 2
#BRSP52-SPRINGG



KUDU™ 52mm Solid Axle Coil Spring Yellow (Hard) x 2
#BRSP52-SPRINGY

#BRLC7088

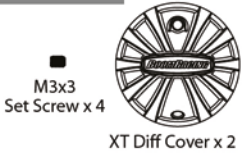

M3x3 Set Screw x 4

XT Diff Cover x 2



Joint Retainer x 8



Shock End Pivot x 4



16T Spur Gear x 1



33T Spur Gear x 1



25T Spur Gear x 1

#BRLC70201-GEAR

#BRX020069



Left Support x 1



Right Support x 1

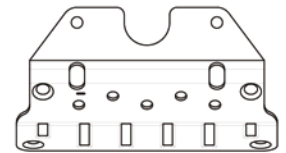

Front Skid Plate x 1



80mm Damper x 2

#BRSH0080



Aluminum Fairlead x 1



M2x6 SC x 2

#BRX023965



Shackle Retainer x 2



Shackle x 2



Shackle Mount x 2

Shackle Pin x 2

M2.5x6 RS x 2

M3x8 RS x 2

M2.5x5 CSS x 4

M3x14 CSS x 2

Preparation Tips

- Work in a clean, well-lit area. Organize all screws and parts before starting.
- Use a sharp marker for trimming lines and deburr all drilled holes.
- Apply thread locker (Loctite) on all metal-to-metal fasteners where vibration is expected.

1



Ø1.2mm Drill Bit

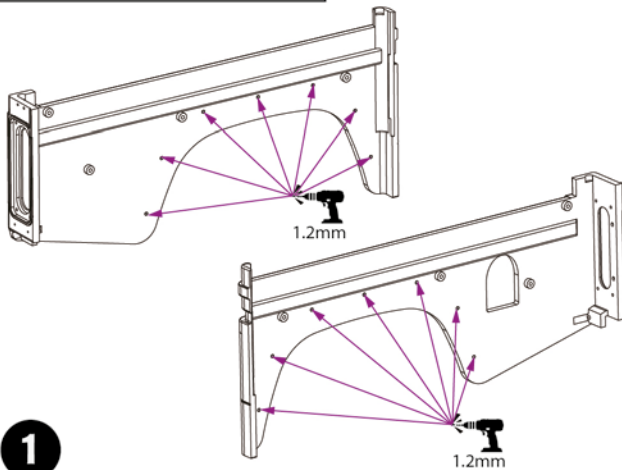

1

Using the provided 1.2mm drill bit, drill through the indicated locations on both rear bed side panels.

2



ST1.5x4 RS x 14

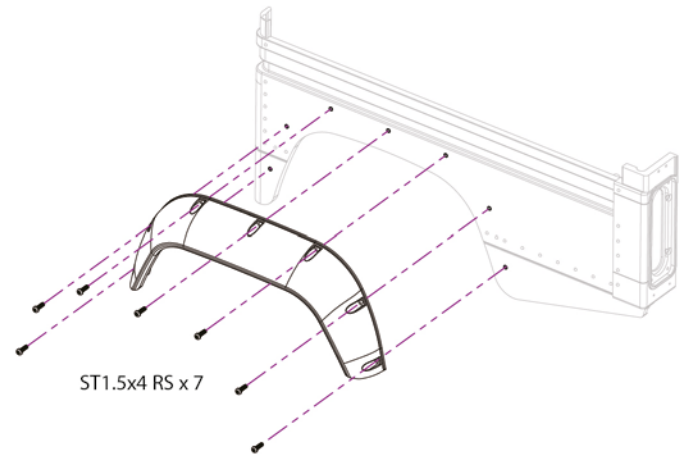

2

Attach both rear wide arches to the rear bed side panels using fourteen ST1.5x4 screws. Once secure, mark along the inside edge of each arch for excess plastic to be trimmed. Trim carefully to your desired fit.

3

Decal Sticker



Ø1.2mm Drill Bit

3

Align the front arch guide with the main front body. Using a 1.2mm drill bit, drill the first three holes.

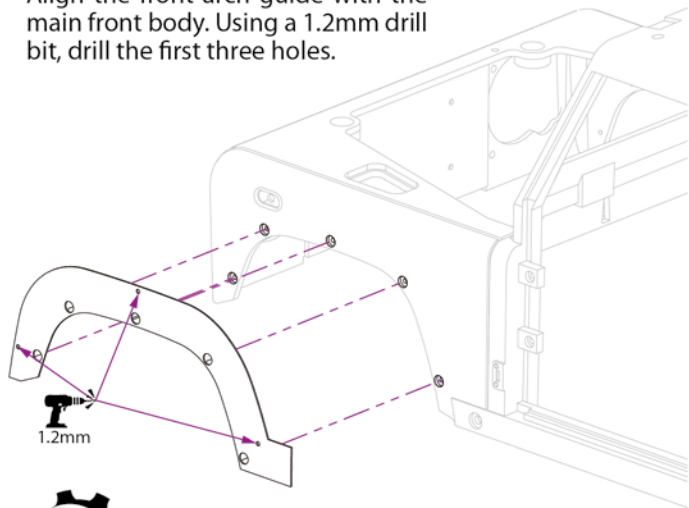
**4**

ST1.5x4 RS x 6

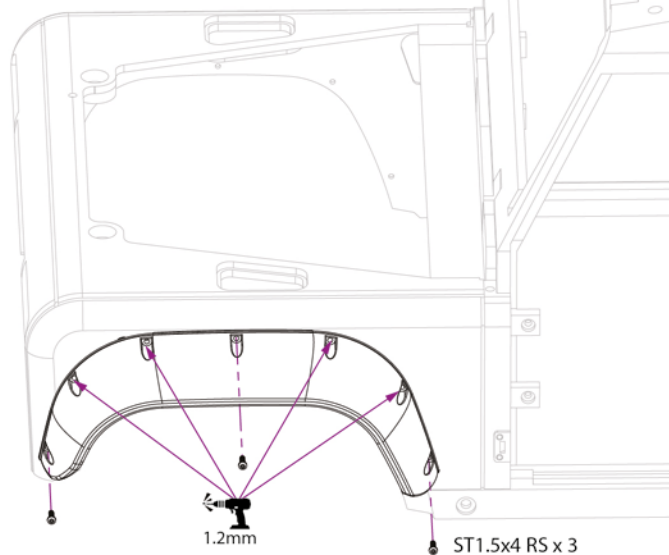

Ø1.2mm Drill Bit

**4**

Secure the front wide arch using three ST1.5x4 screws in the pre-drilled holes. Use the arch itself as a guide to drill the remaining four holes for better accuracy.

5

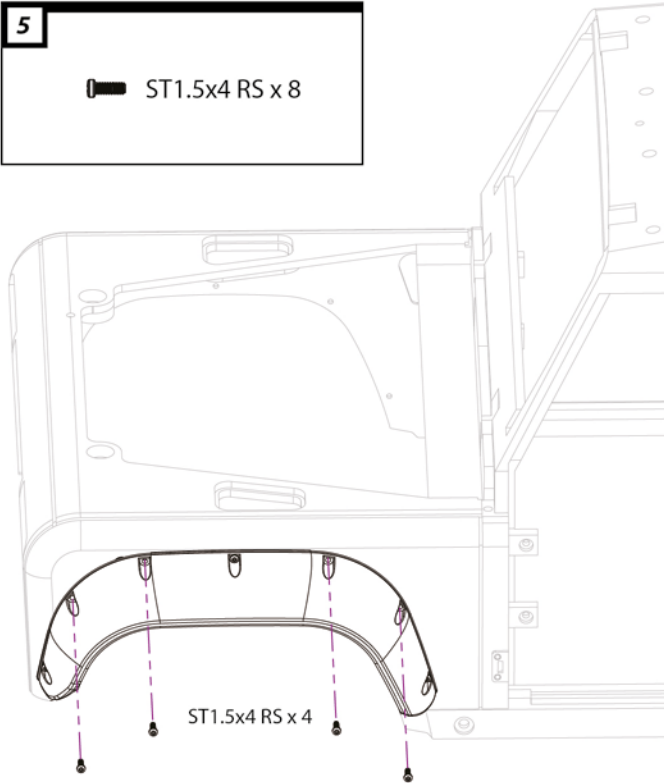
 ST1.5x4 RS x 8

5

Install the final four ST1.5x4 screws.

6

Dry-fit the headlight panel, then mark along the inside edge of the arch and under the headlight panel for trimming. Trim carefully to your desired fit. Repeat for the opposite side.

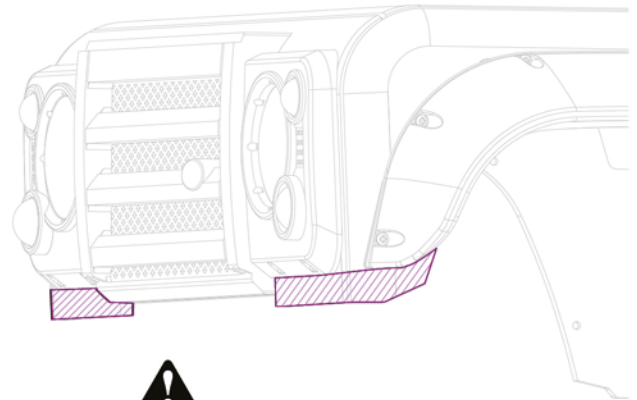

Pay attention for trimming

7

- ST1.5x4 CSS x 4
- ST1.5x4 RS x 4
- ST2x6 RS x 2

7

Attach the metal grille to the front center grille panel with four ST1.5x4 screws, then glue the assembly to the main body as indicated. Glue the headlight assembly together and glue it to the main body in the marked position. Install both new metal mirror brackets using four ST1.5x4 screws. Re-attach the mirror housing to the bracket with two ST2x6 screws. Install the new metal mirrors onto the housings.

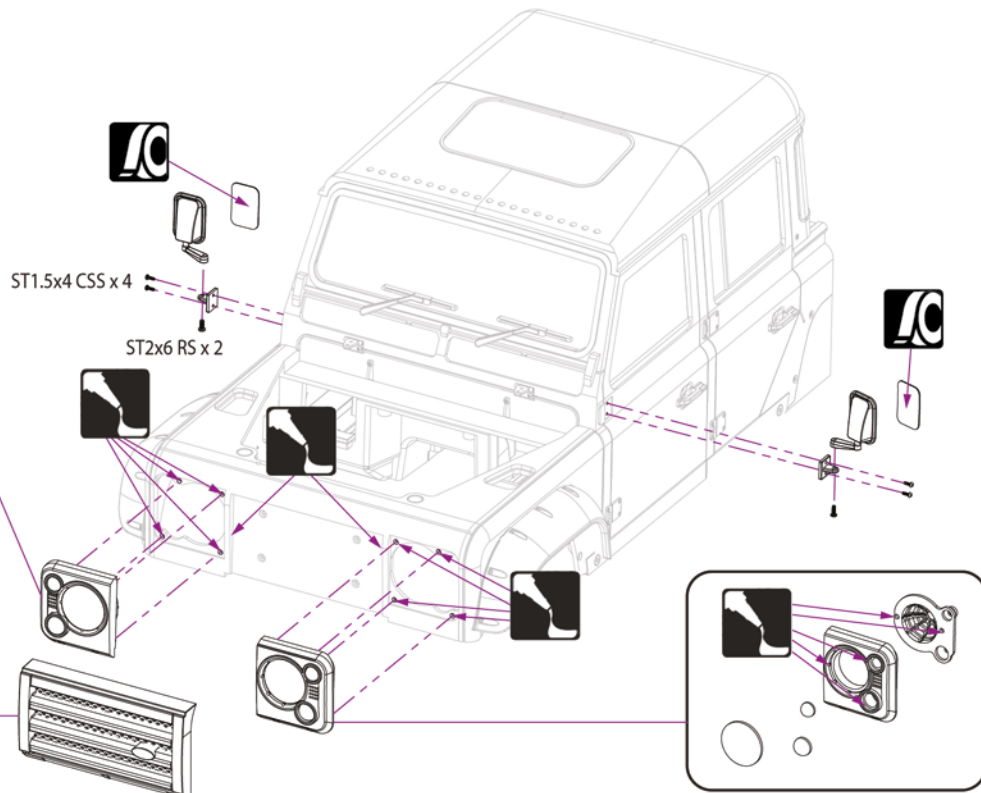
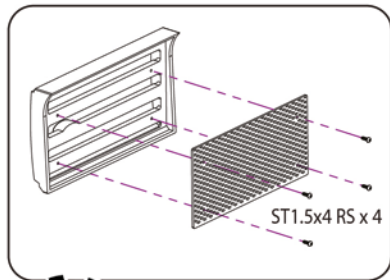
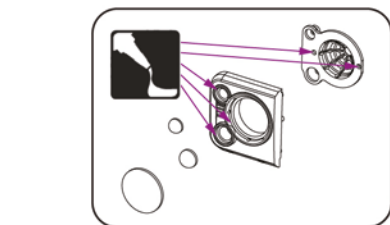

7

Align the new metal windscreen cage on the body. Using a 1.7mm drill bit, drill all mounting holes. Secure the cage with four ST2x8 screws and three ST2x6 screws as indicated.

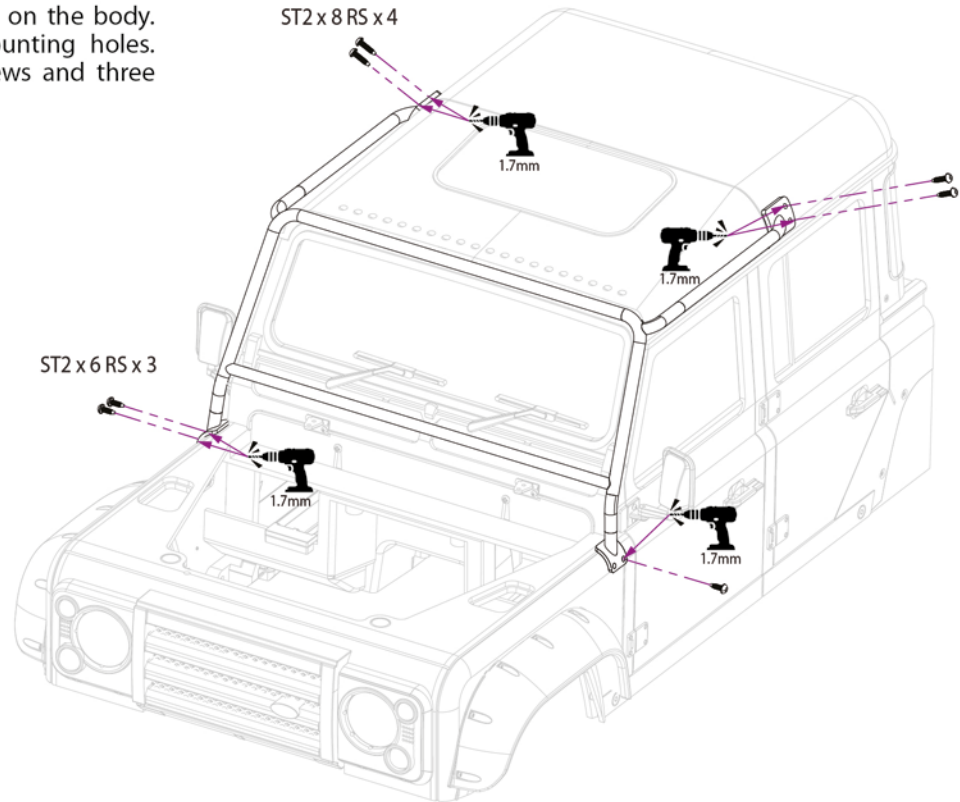

8

 ST2x6 RS x 3

 ST2x8 RS x 4

Ø1.7mm Drill Bit

9

ST1.2x4 RS x 5



Ø1.0mm Drill Bit

9

Clip the snorkel onto the windscreen cage and align the lower mounting points with the body. Using a 1.0mm drill bit, drill the five mounting holes. Secure with five ST1.2x4 screws.

Glue the snorkel components together as shown.

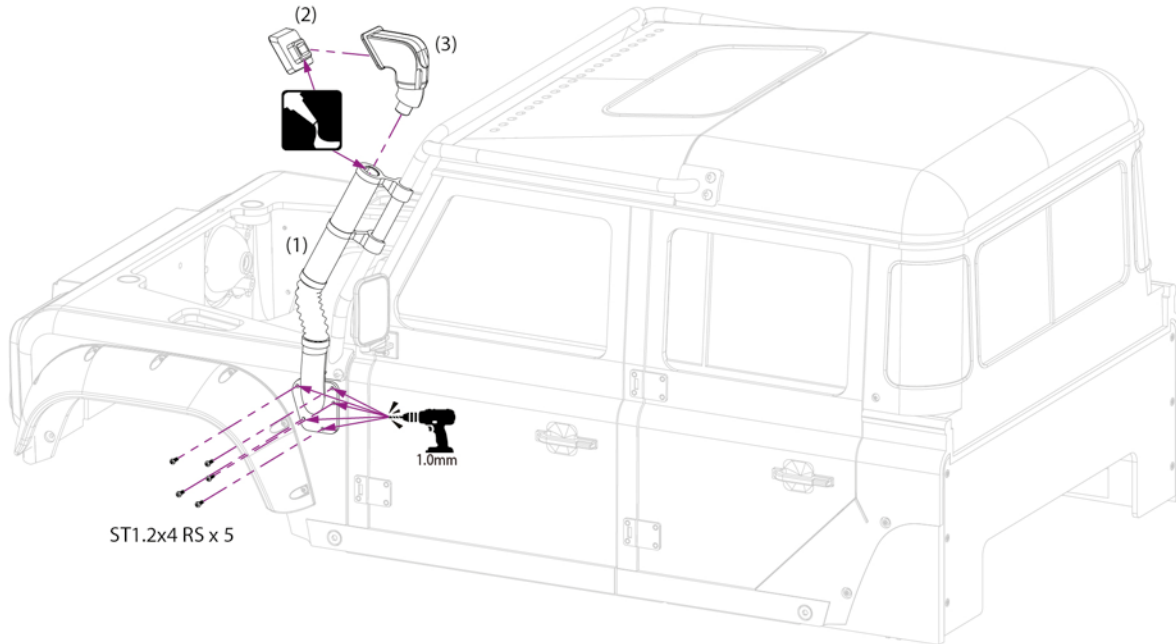

10

Choose your preferred top and side air vent style. Glue them into position as indicated.



Style 1



Style 2



Style 3

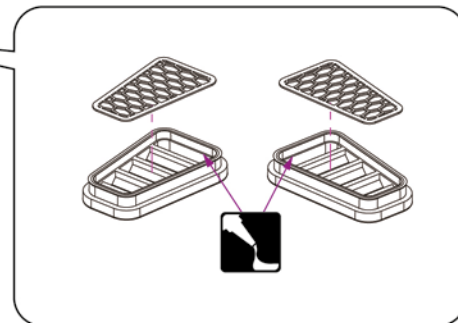
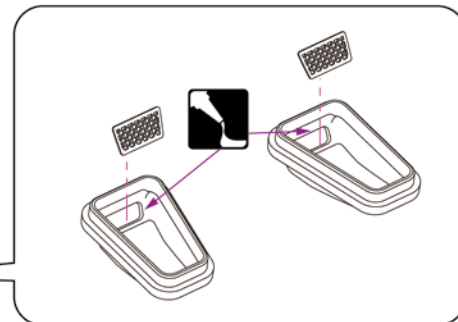
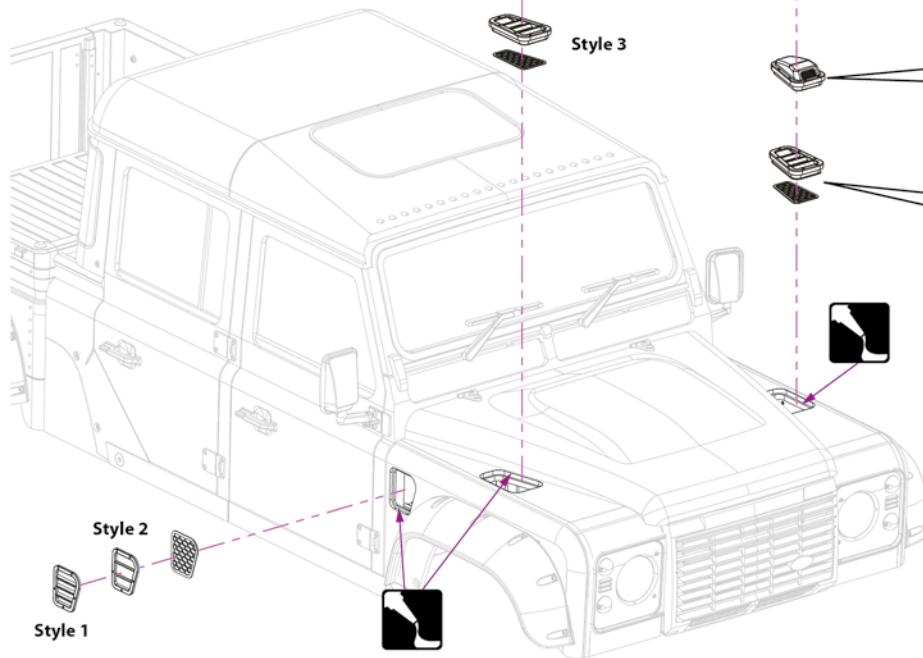

Style 2

Style 1

11

M3x6 CSS x 6

M3x6 CSS x 6

11

Attach the steel rock sliders to the bottom of the quick-release and blanking plate using six M3x6 screws.

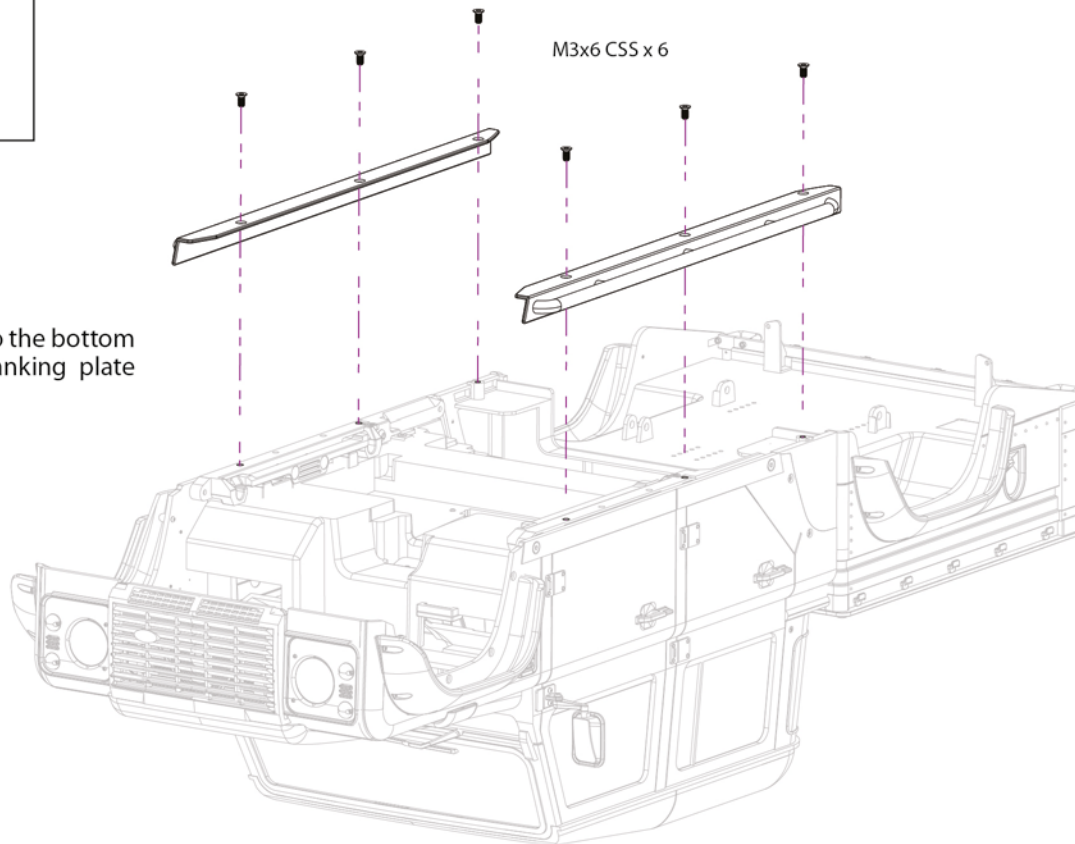

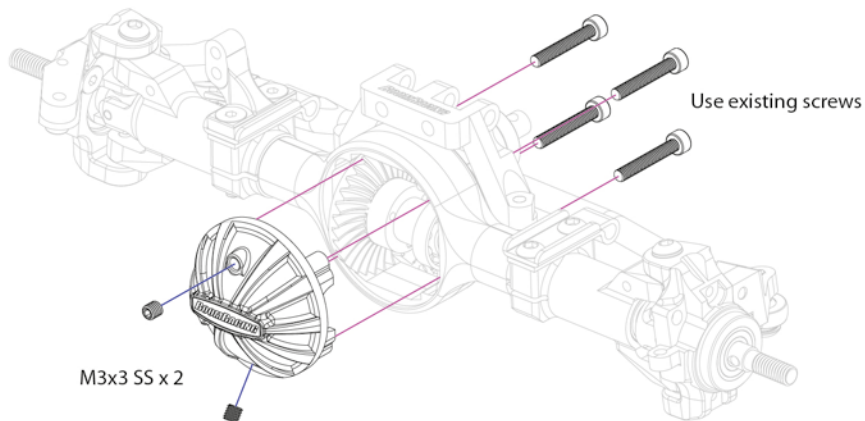
12

Remove the stock diff cover and install the XT diff cover with the existing screws. Install two M3x3 grub screws into the diff cover (apply Loctite to the grub screws).

Repeat for the other axle.

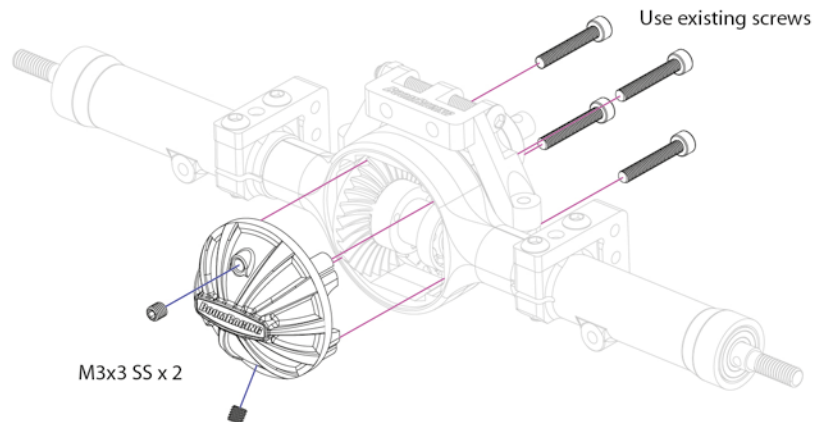

12



M3x3 SS x 4

13

Assemble the front skid plate as shown in the diagram and attach it to the chassis in the designated locations.

13

 M2.5x5 CSS x 4

 M2.5x6 RS x 2

 M3x8 RS x 2

 M3x14 CSS x 2

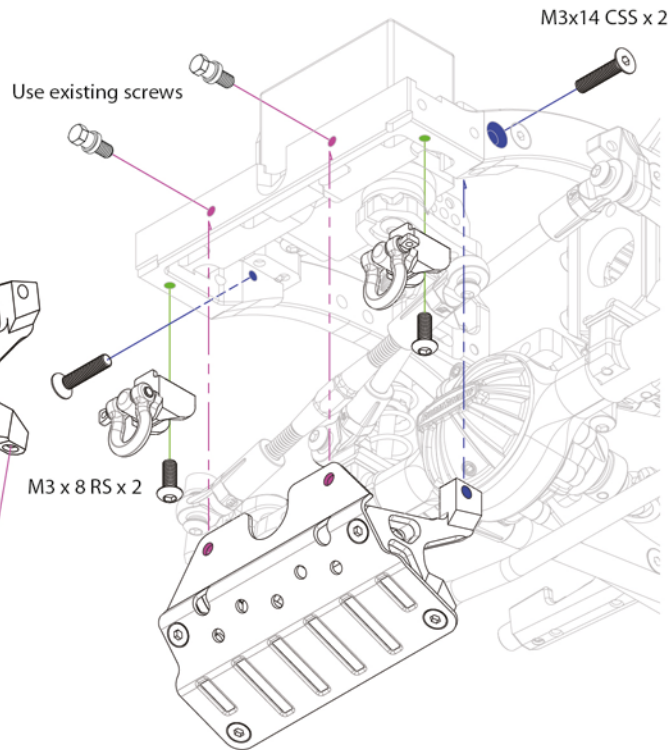
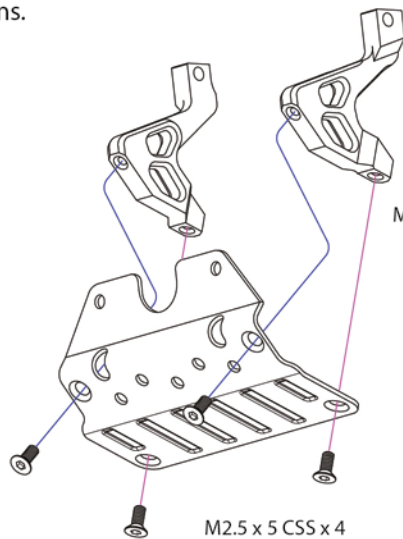
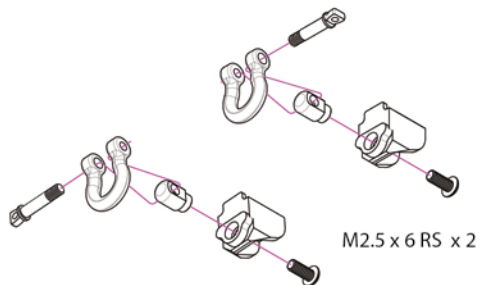

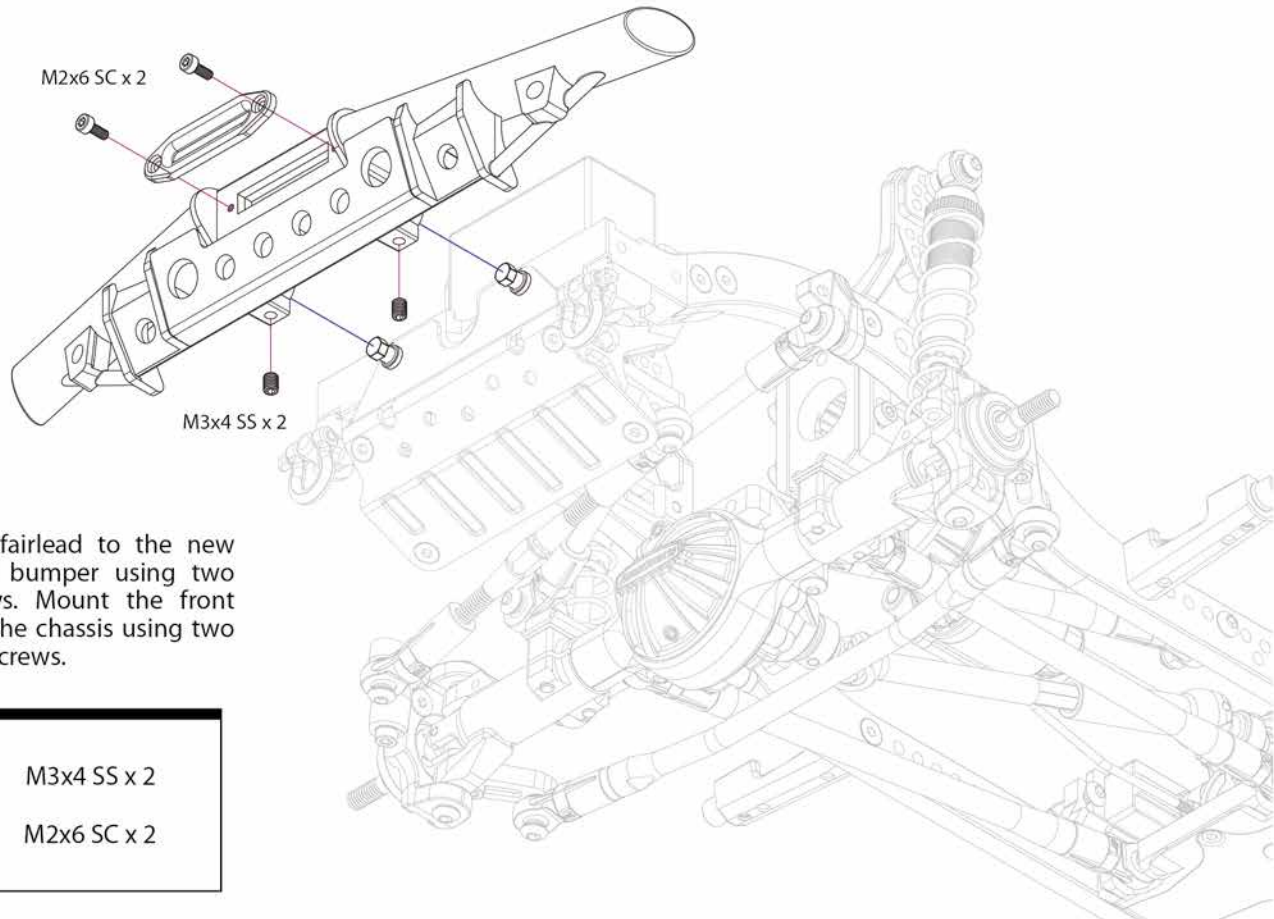
14

Attach the fairlead to the new metal front bumper using two M2x6 screws. Mount the front bumper to the chassis using two M3x4 grub screws.

14

M3x4 SS x 2



M2x6 SC x 2

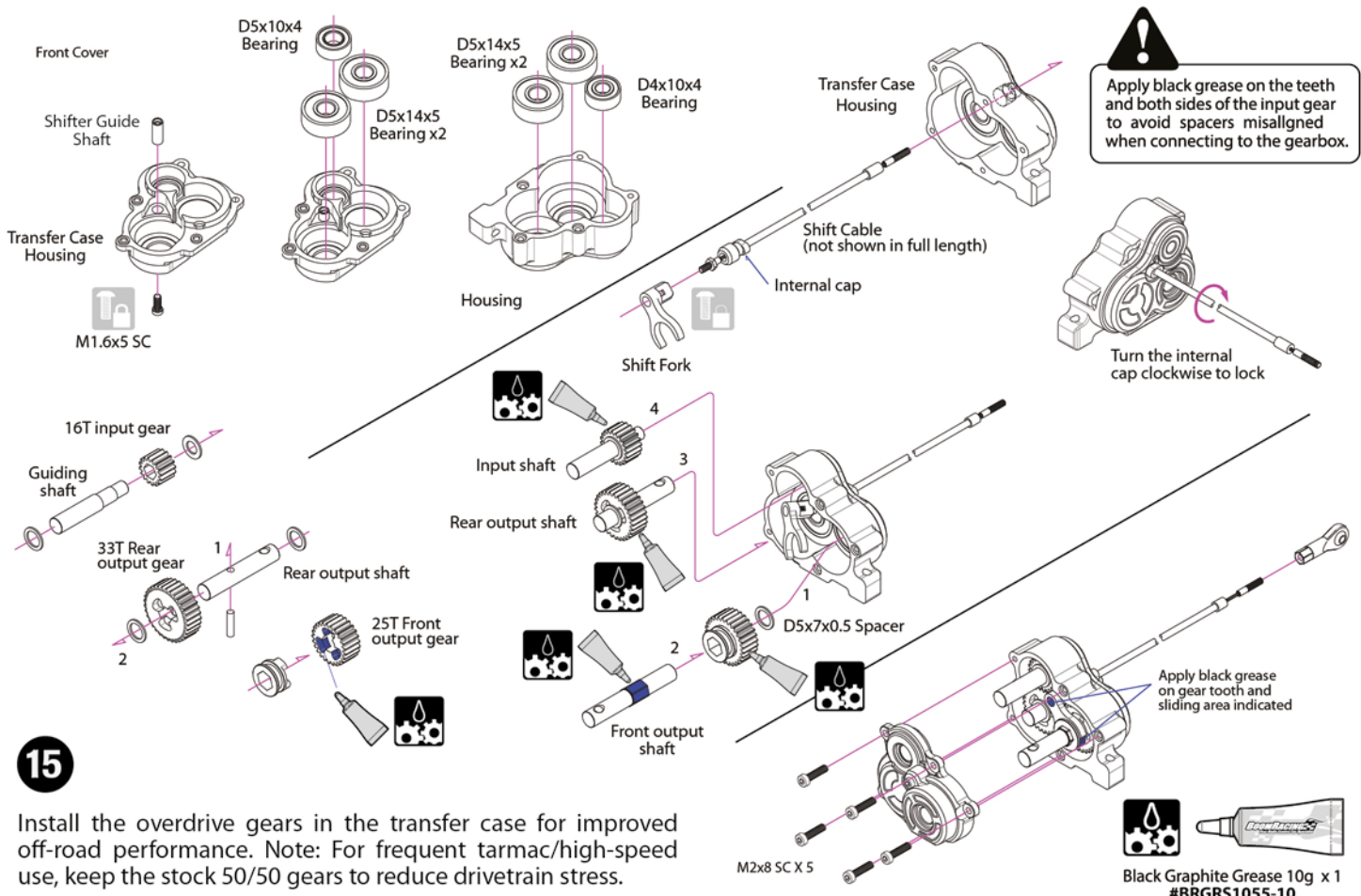

15

Install the overdrive gears in the transfer case for improved off-road performance. Note: For frequent tarmac/high-speed use, keep the stock 50/50 gears to reduce drivetrain stress.



Use existing screws

16

Add 1mm spacers to both the upper and lower front links as indicated. Use the lower shock mounting position shown in the diagram.

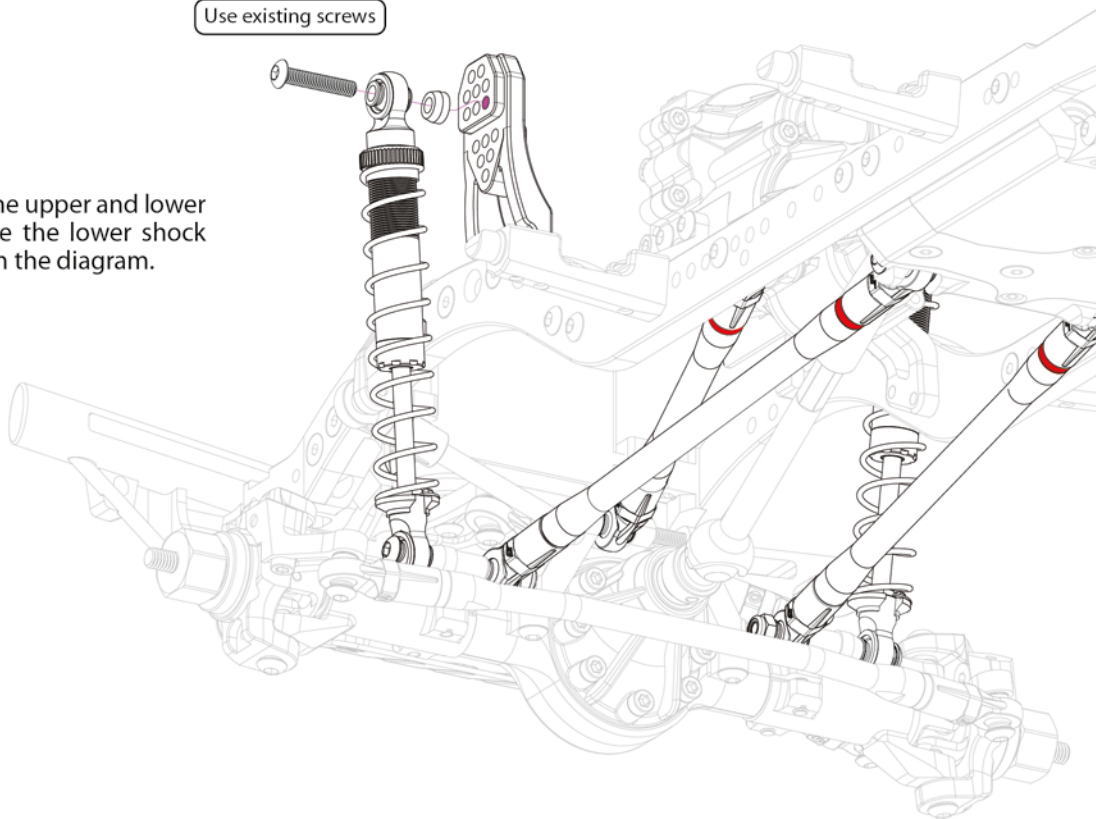

17

- Replace the rear springs with the longer ones.
- Replace the rear 70mm shock absorbers with the longer 80mm version and mount them in the indicated positions
- Change the rear wheel hex adapters from 5mm to 8mm width .

17

Come in stock box (Bag C)



8mm Wheel Hex x 4
#BRLC7056

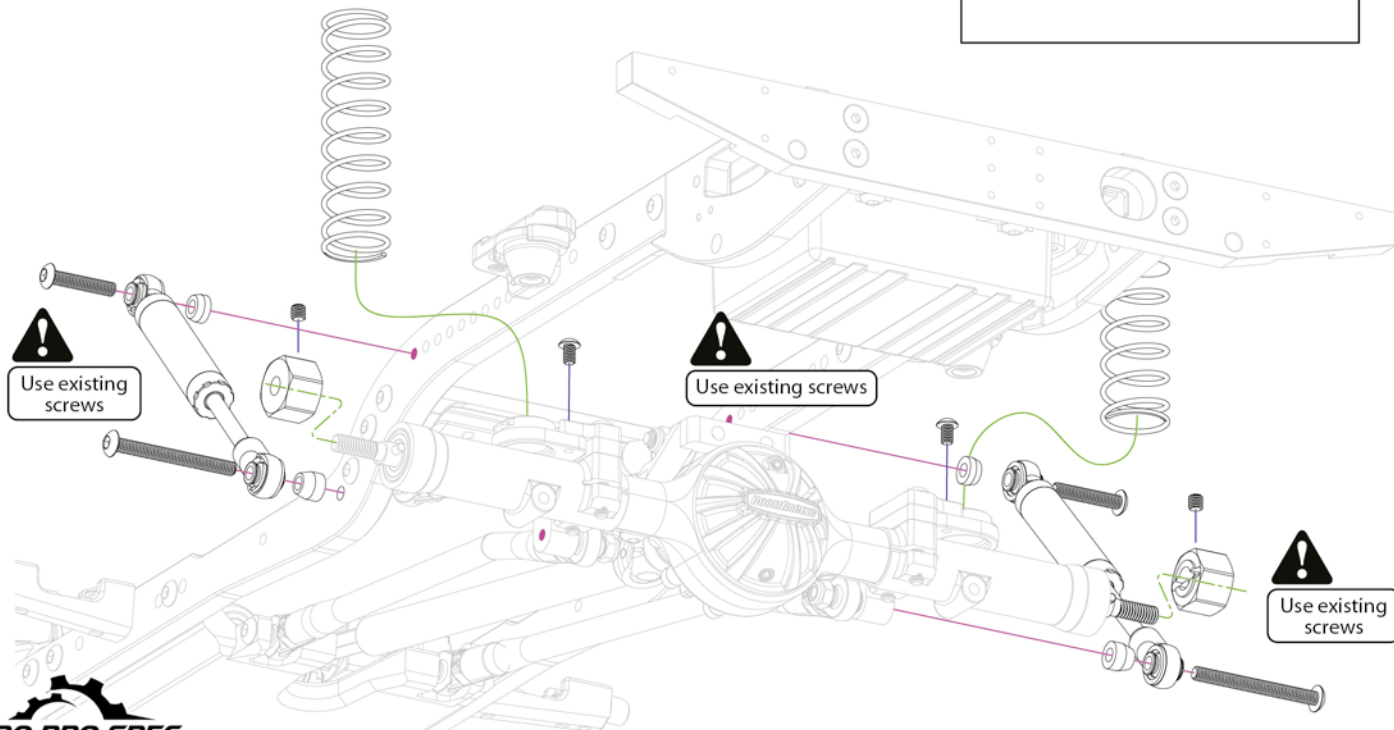

18



M3x6 RS x 2

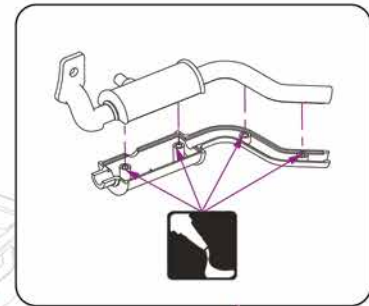
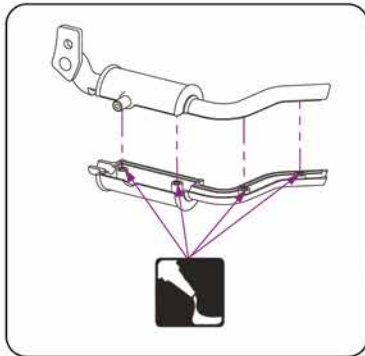

M3x6 RS x 2

18

Glue the exhaust components together as shown. Once assembled attach it to the chassis with two M3x6 screws as indicated.

19

Mount the TPD tires onto the ProBuild wheels using the smaller (more inward) offset.

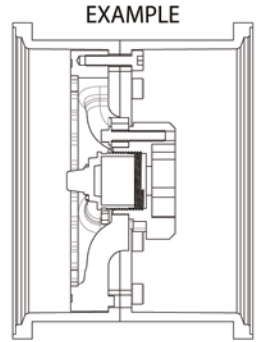
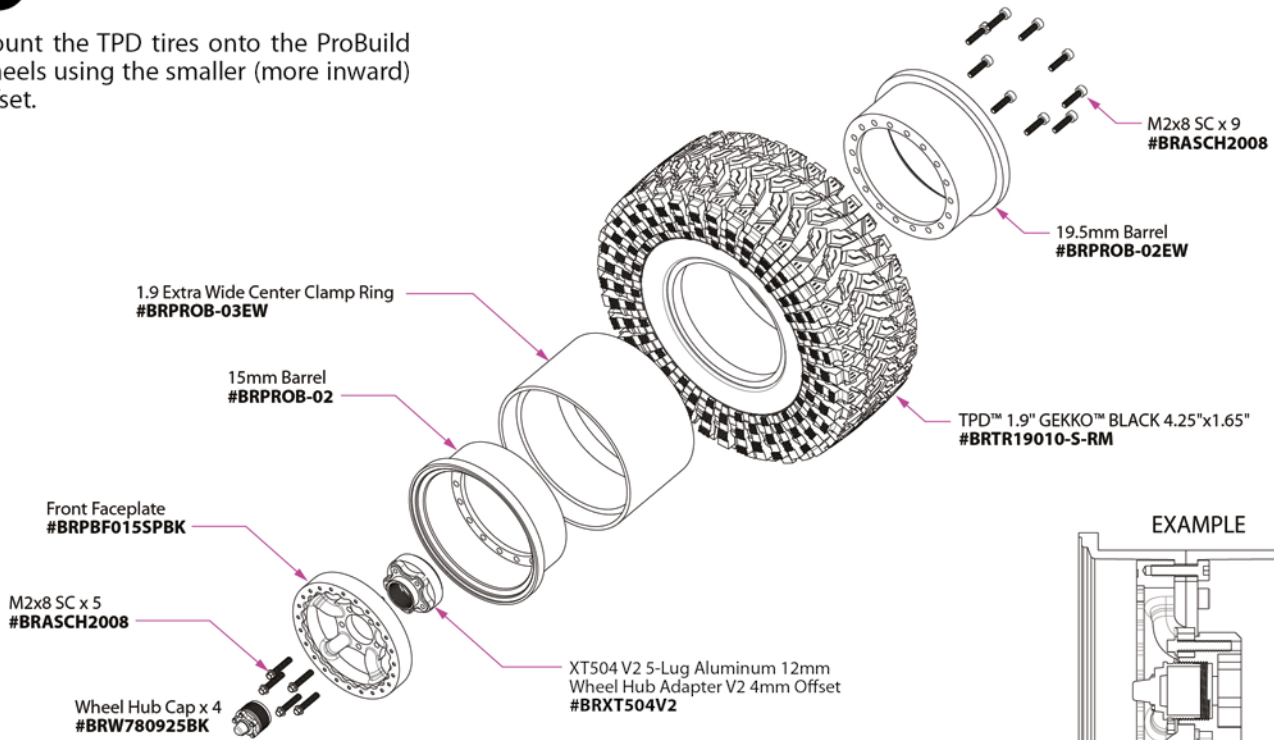

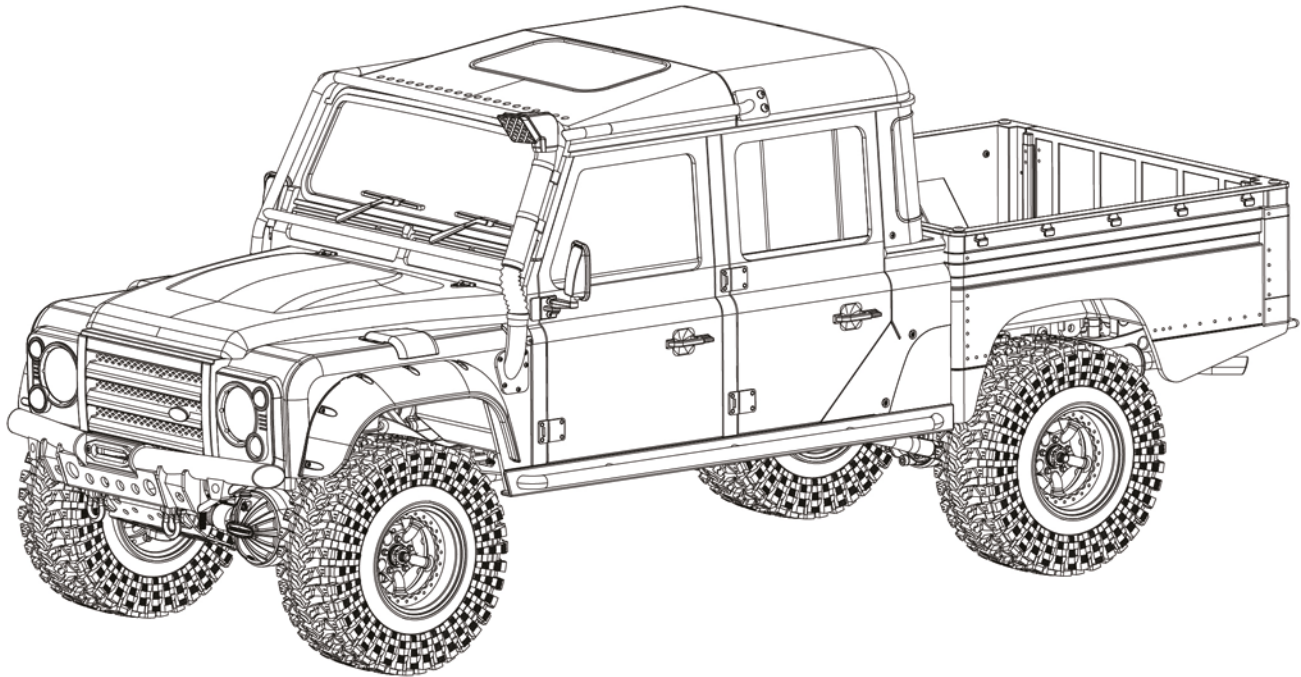



 @BOOM_RACING

 BOOMRACINGRC

 SALES@BOOMRACING.COM

www.EnjoyBeingABadass.com

BOOMRACING  [®]
Your Radio Control Car Specialist